



## 111 Belle Aire Holiday Estate Beach Road

, Hemsby, NR29 4HZ

£34,000



Aldreds are pleased to offer this very well presented two bedroom terraced, holiday chalet facing in a westerly direction and located in the popular Belle Aire Chalet Park. The chalet is well equipped and offers a modern fitted kitchen, shower room, two bedrooms and spacious living area. The chalet also offers the benefit of uPVC double glazed windows and doors. The property would make an ideal investment property.



Lounge/Kitchen 15'3" max 8'3" min x 14'8" max 9'6" min (4.65 max 2.54 min x 4.48 max 2.9 min)

Door to front, double glazed window to front aspect, electric cooker point, base storage units with worktops, sink with drainer

Bedroom 1 9'3" x 7'2" (2.82 x 2.2)

Double glazed window to rear aspect

Bedroom 2 9'3" x 6'10" (2.82 x 2.1)

Double glazed window to rear aspect

Shower Room 7'1" x 4'7" (2.16 x 1.42)

Shower in cubicle, hand basin, low level WC, opaque double glazed window to front aspect

#### Outside

Communal gardens and parking

#### Tenure

Leasehold. 48 years left on lease. Ground rent and ground rent approx £2400 with an additional payment of around £1500 needed to extent to to 11.5 month season. All payments are variable

#### Services

Water, electricity, drainage

#### Council Tax

Business Rated - Previously Band A

#### Location

Hemsby is a coastal village approximately 7 miles north of Great Yarmouth. The tourist-based part of the village lies along Beach Road and is commonly known as Hemsby Beach. At the beach end of the road are a number of cafes, shops and amusement arcades, ten-pin bowling, bingo, a play area and many different machines. A variety of seaside-style cafes and restaurants are available, offering sit-down meals, take-away fish and chips and Chinese food. Fun fairs, crazy golf courses and children's rides also feature on a number of sites along the street.

#### Directions

From the Yarmouth office head north along the A149 Caister Road, continue past the Yarmouth Stadium, at the roundabout turn left onto the Caister Bypass, continue over the next roundabout into Jack Chase Way, continue over the next roundabout into Scratby Road, continue into Yarmouth Road, continue into Kings Way, at the mini roundabout turn right into Beach Road, turn right into Belle Aire Chalet Park

Ref Y12735/05/26

## Area Map

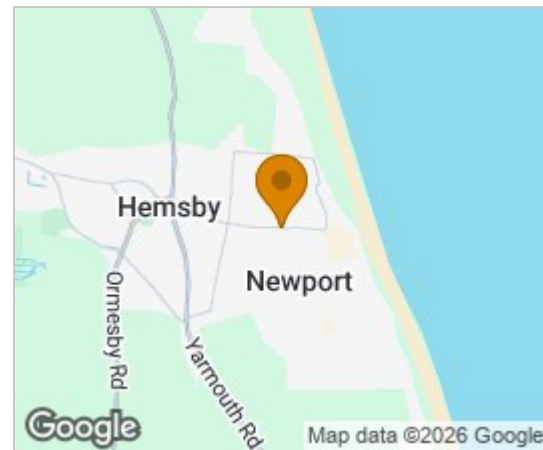

## Floor Plans

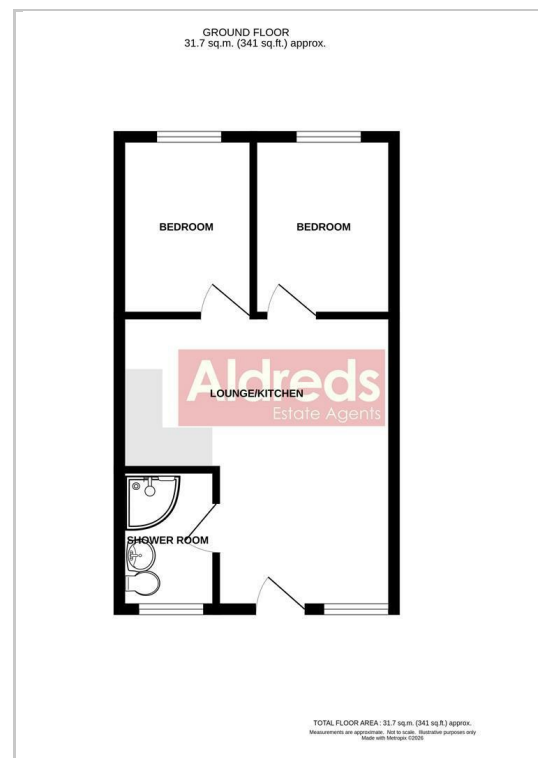

## Energy Efficiency Graph

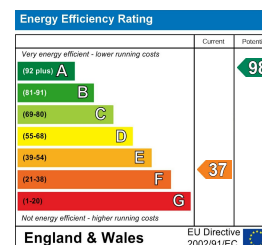

#### Disclaimer

These particulars are issued on an understanding that all negotiations shall be conducted through Messrs. Aldreds. Please note: Messrs. Aldreds for themselves and for the vendors or lessors of this property whose agents they are given notice that: 1. Particulars are set out as a general outline only for guidance of intending purchasers or lessees, and do not constitute nor constitute part of, an offer or contract. 2. All descriptions, dimensions, references to condition and necessary permissions for use and occupation, and other details are given without responsibility and any intending purchasers or tenants should not rely on them as statements or representations of fact but must satisfy themselves by inspection or otherwise as to the correctness of each of them. 3. No person in the employment of Messrs. Aldreds has any authority to make or give any representation or warranty whatever in relation to this property. 4. If you are proposing to visit the property and are travelling some distance please check with Aldreds on the issue of availability prior to travelling. 5. Aldreds Property Consultants and associated services may offer additional services to the prospective purchaser for which they will be entitled to receive a commission.

Aldreds are pleased to be working with Mortgage Advice Bureau. They're an award-winning mortgage broker with over 1,400 advisers across the UK, and have access to over 12,000 mortgage products from over 90 lenders. Aldreds Estate Agents Ltd receive a commission of £200 on each completed case. Your home may be repossessed if you do not keep up repayments on your mortgage. There may be a fee for mortgage advice. The actual amount you pay will depend upon your circumstances. The fee is up to 1%, but a typical fee is 0.3% of the amount borrowed. Mortgage Advice Bureau is a trading name of Mortgage Seeker Limited which is an appointed representative of Mortgage Advice Bureau Limited and Mortgage Advice Bureau (Derby) Limited which are authorised and regulated by the Financial Conduct Authority. Mortgage Seeker Limited Registered Office: Lovewell Blake, Sixty Six North Quay, Great Yarmouth, Norfolk, NR30 1HE. Registered in England Number: 03721415. 6. Potential purchasers should check with their providers that the broadband and mobile phone coverage they would require is available.

17 Hall Quay, Great Yarmouth, Norfolk, NR30 1HJ

Tel: 01493 844891 Email: yarmouth@aldreds.co.uk <https://www.aldreds.co.uk/>

Registered in England Reg. No. 08945751 Registered Office: 17 Hall Quay, Great Yarmouth, Norfolk NR30 1HJ Directors: Mark Duffield B.S.c. FRICS. Dan Crawley MNAEA Paul Lambert MNAEA